

# WARD CONNECTOR

**J Corner and H Corner**  
FOR USE WITH J AND H DUCT FLANGE

**CNR**

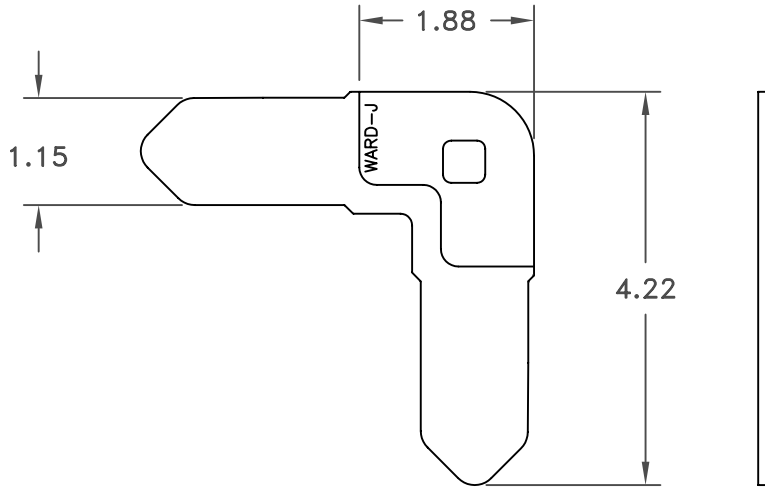

**J Corner**

SPECIFICATIONS:

1. J corner formed from 12 gauge metal
2. H corner formed from 12 gauge metal

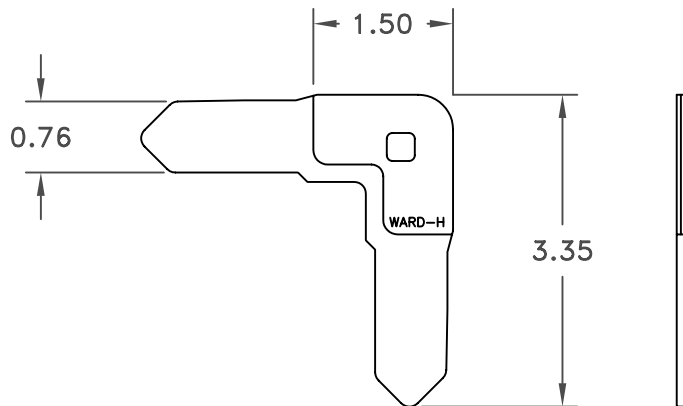

**H Corner**

NOTES:

1. Use J corners with Ward J flange.
2. Use H corners with Ward H flange.
3. J corners are available in the following:
  - Galvanized
  - Galvaneal
  - Aluminum
  - Aluminized
  - Stainless Steel
4. H corners are available in the following:
  - Galvanized
  - Galvaneal
  - Aluminized
5. Nuts and bolts included (galvanized)

JOB NAME: _____	SUBMITTED BY: _____
LOCATION: _____	
ARCHITECT: _____	
ENGINEER: _____	
CONTRACTOR: _____	



500 E. Eighth Street • Holland, MI 49423  
T (800) 466-9374 • F (866) 466-9335 • www.wardind.com