

# WARD FIRE DAMPER

## Thinline Curtain Style Fire Damper

1 1/2 HOUR U.L. LABELED FOR USE IN 2 HOUR FIRE SEPARATIONS OR LESS

85VA  
85HA

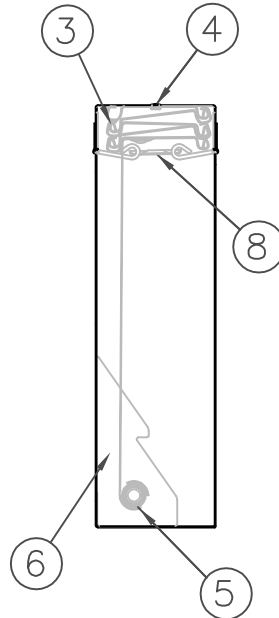
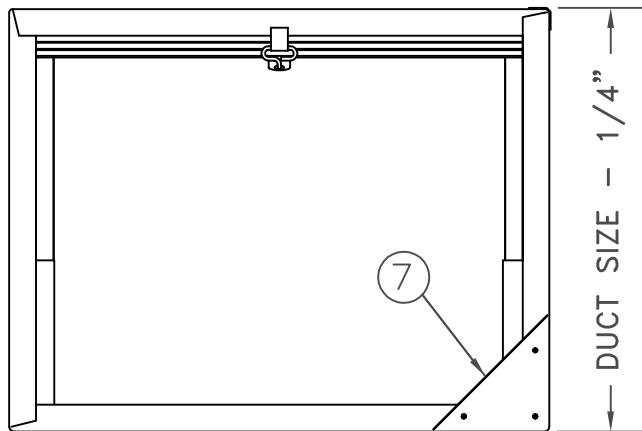
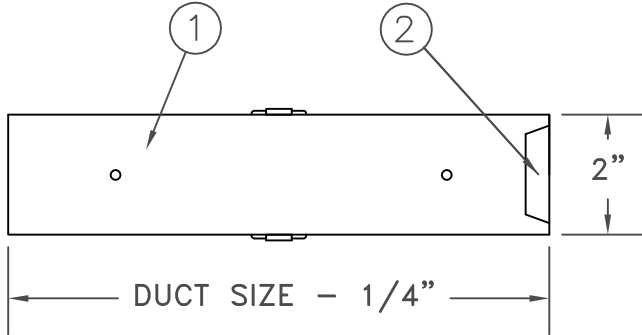

### SPECIFICATIONS:

1. Rollformed 22 gauge steel frame
2. Self locking corner
3. Interlocking 22 gauge steel blade
4. Top blade riveted to frame
5. Stainless steel closure spring (HA)
6. Blade lock ramp (HA)
7. Gusset (for units greater than 48")
8. Fusible link
  - 165° - Standard
  - 212° - Optional
  - 286° - Optional

### NOTES:

1. Tested to UL 555: File R16475.
2. Meets requirements of NFPA 90A.
3. Listed with California State Fire Marshal: Listing #3225-1577:100.
4. Vertical (VA) or horizontal (HA) models.
5. Maximum single unit size:
  - Vertical: 41"x36" or 36"x60"
  - Horizontal: 41" x 36"
6. Galvanized steel construction.
7. Reference 85/95 Series sizing chart for damper sizing (separate).
8. For installation instructions see 85 Series Installation Instructions.

JOB NAME: _____	SUBMITTED BY: _____
LOCATION: _____	
ARCHITECT: _____	
ENGINEER: _____	
CONTRACTOR: _____	